



Important information

After (seasonal) use, make sure the Fairybell® is completely dry. Lay the Fairybell® out on the ground and tie the orange ribbons around various sections of the Fairybell® (straps with lights) so that next season you start with an untangled Fairybell®.

When placing the Fairybell® back into the box, hold the top hook and lower the bottom part (plugs and elastics) first into the box and finish on top with the hook. Always store the Fairybell® in a clean and dry place. Lower the Fairybell® at windforce 6 or higher.

Missing parts or defects

All spare parts can be ordered at our webshop. See 'service request' at our webshop.

Need help?

Do you need help with placing the Fairybell®? Scan the QR code below to watch the instructional videos from our products.

Scan QR for our instructional videos



www.fairybell.com

Download the Tuya App and start your Fairybell® Magic today!



Fairybell® is a registered trademark of Hemsson Holding BV www.fairybell.com

This is a worldwide patented product | Certifications: CE and RoHS compliant | FSP0958



Fairybell® Smart Magic



Assembly instructions - Opbouw instructies
Aufbauanleitung - Instruction de construction
Istruzioni di assemblaggio - Monteringsanvisning

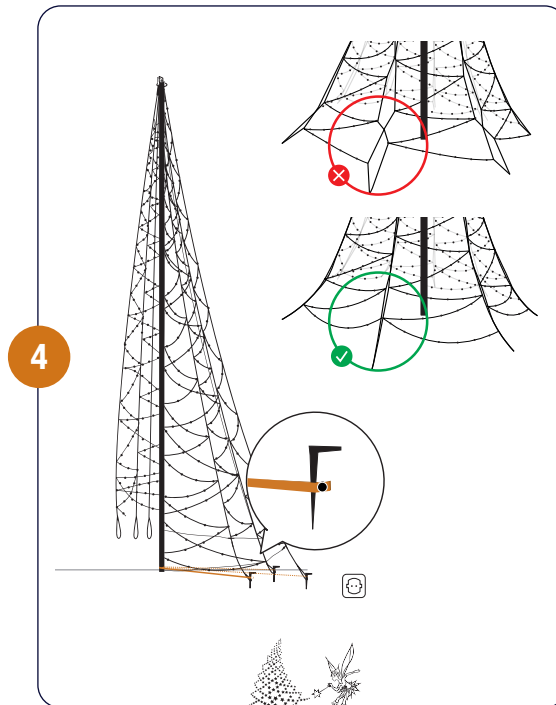
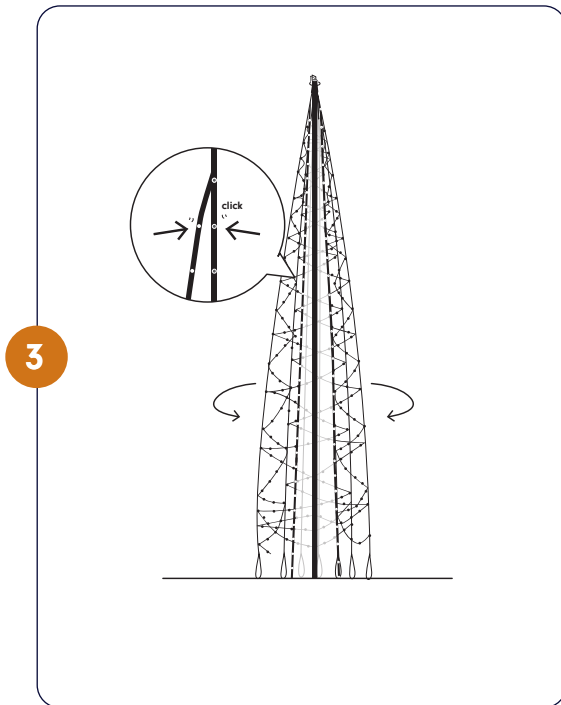
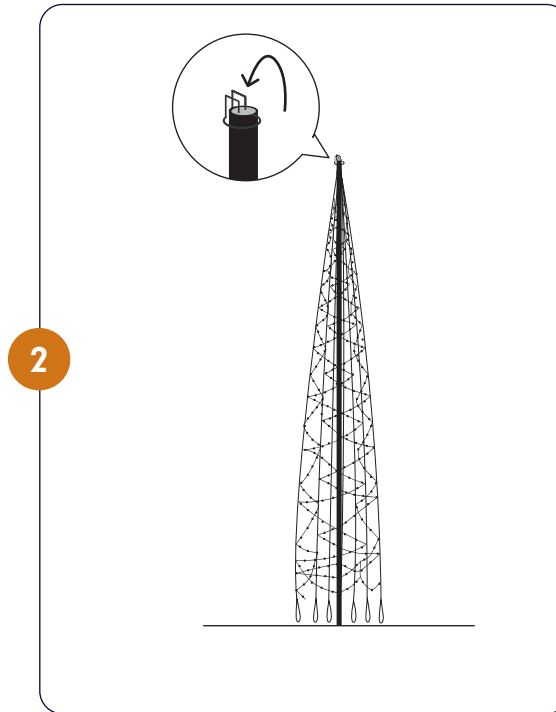
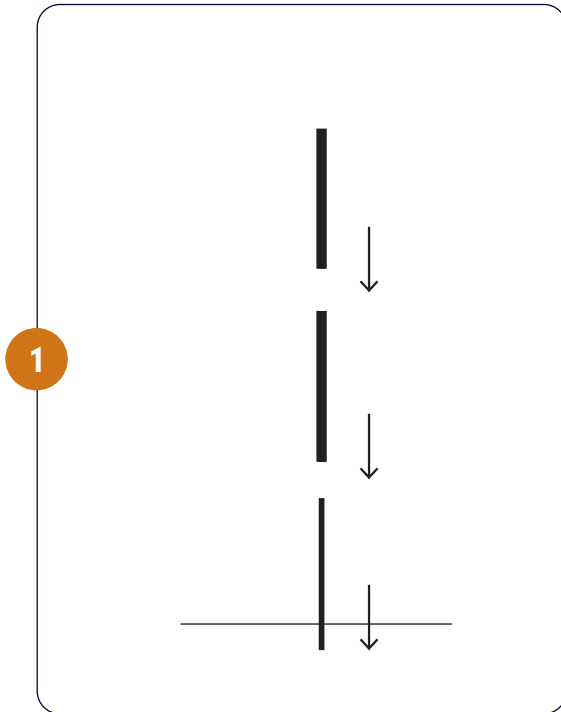

How to start your Fairybell[®] Magic.

1. Download the Tuya app in the App Store or Play Store.
2. Make a new account or log-in to an existing account.
3. To add Fairybell Smart Magic press + in the top right corner.

To connect Fairybell Smart Magic with Tuya, make sure that you have followed all the previous steps, you are using a 2.4Ghz network and Fairybell Smart Magic is turned on.

4. Hold the button on the transformer until Fairybell Smart Magic starts to blink.
6. Follow the steps in the Tuya app to connect Fairybell Smart Magic.

